



D&AD
ADNAMS

GR3333 COMPETITION BRIEF

The Brief:

Connect to a new generation of drinkers outside of East Anglia, shake preconceptions and make sustainability taste good with a positive and memorable experience.

Solution: The Adnams Beer Garden

The Adnams Beer Garden is a unique, relaxed and portable social space. Crafted from brewing ingredients and reclaimed materials, it tells the Adnams story, and highlights how sustainable business can benefit us all.

Launching at the Chelsea flower show. The Adnams Beer Garden will then tour the country throughout summer, sharing it's sustainability story with the public over a nice cold pint.

ADNAMs. SOUTHWOLD BEER GARDEN

The Adnams beer garden will be fully portable (via biofuel HGV) and created almost entirely from recycled / reclaimed materials.

It will tell the adnams story through both typographic elements and several other bespoke garden features.

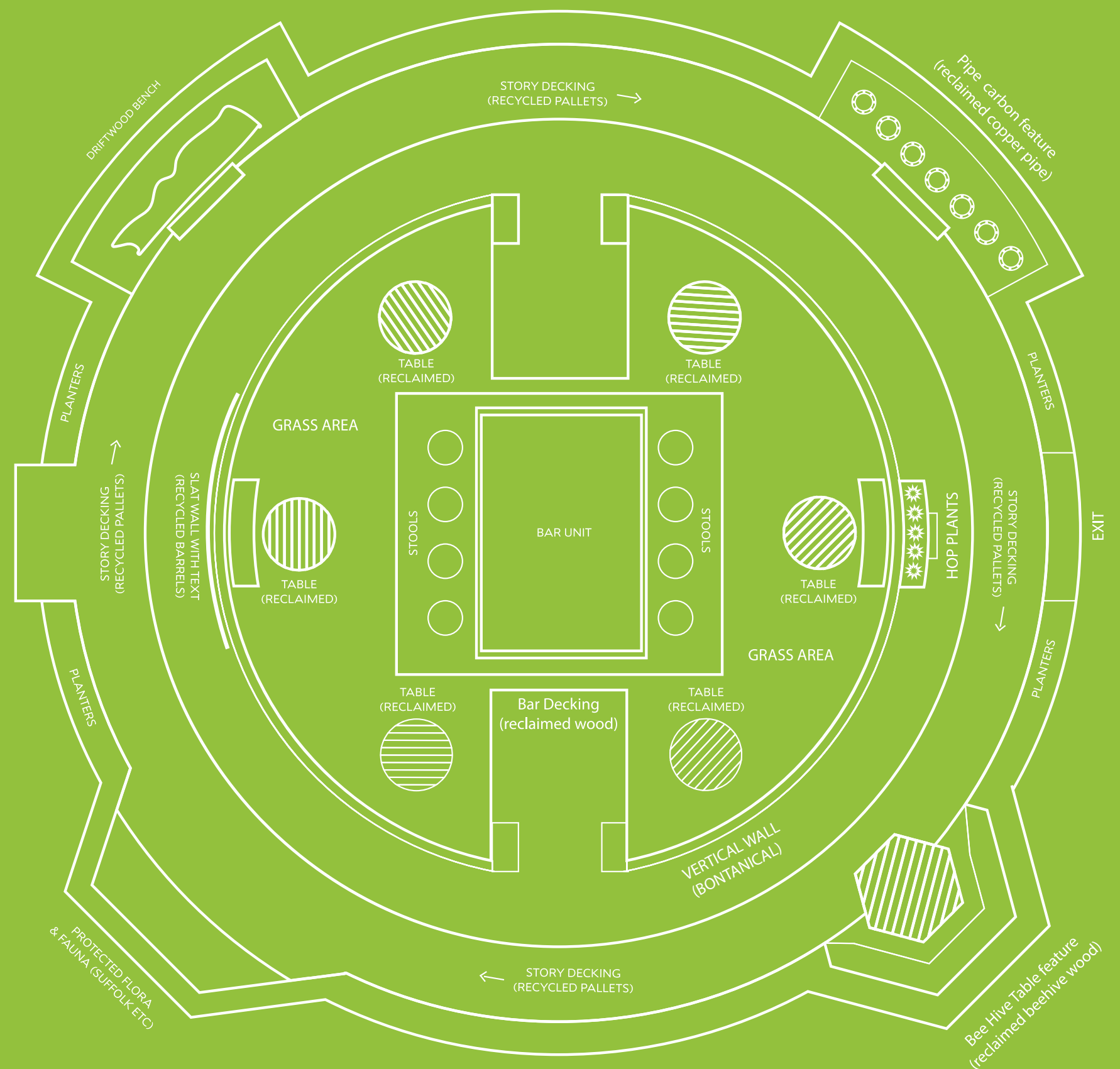

ADNAMs.

SOUTHWOLD

BEER GARDEN

Salvaged driftwood bench feature (dedicated to the volunteers who take part in Adnams annual British beach cleanup).

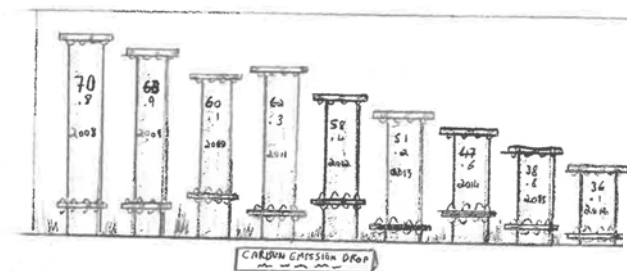

Carbon Graph pipe feature. (old distillery pipes that show carbon emission reductions each year)

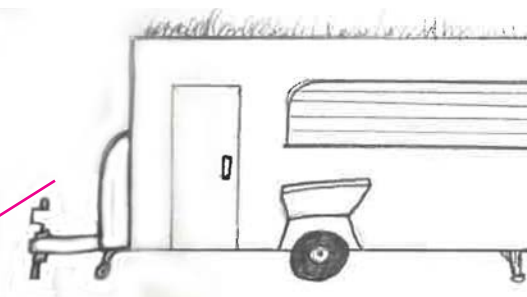

Portable bar trailer unit. (Features a grass roof mimicing the Adnams distribution center.)



Intro wall feature. (Recycled whiskey barrels, and etched with the campaign strapline "most businesses want to make a mark on the world, we'd rather just make good beer")

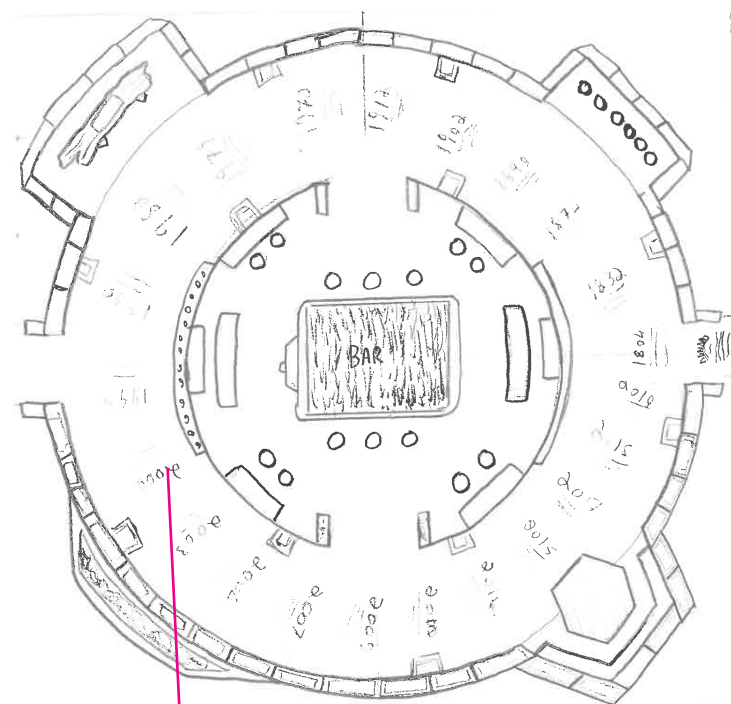

Garden decking. Made from recycled wood pallets, and burn etched. The decking will feature a dated timeline, marking out interesting points in Adnams rich history.

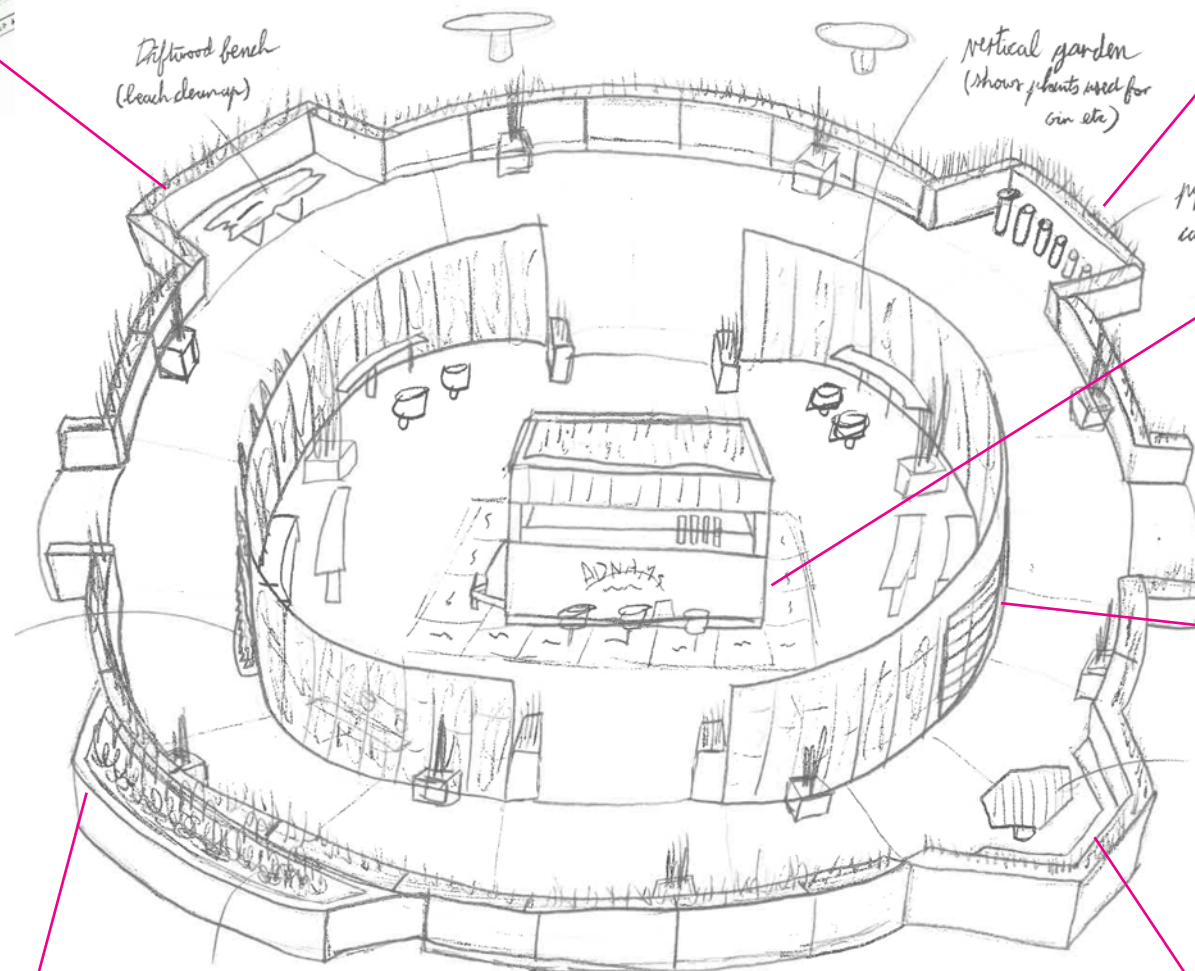

flora & fauna (supported by adnams environmental schemes)

Flower bed, hosting Suffolks offical flower (Oxlip) and displays some of the rare flora & fauna that Adnams protects through various environmental schemes.

pipe graph carbon reduction

vertical garden (shows plants used for gin etc)

bee table

Bench made from hessian bally / grain sacks

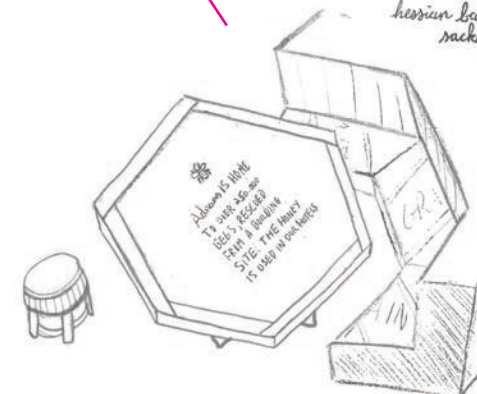

Hexagon BeeTable. Built from wood from the older outgrown beehives, this tells the story of how Adnams rescued its bees.

ADNAMS. SOUTHWOLD BEER GARDEN

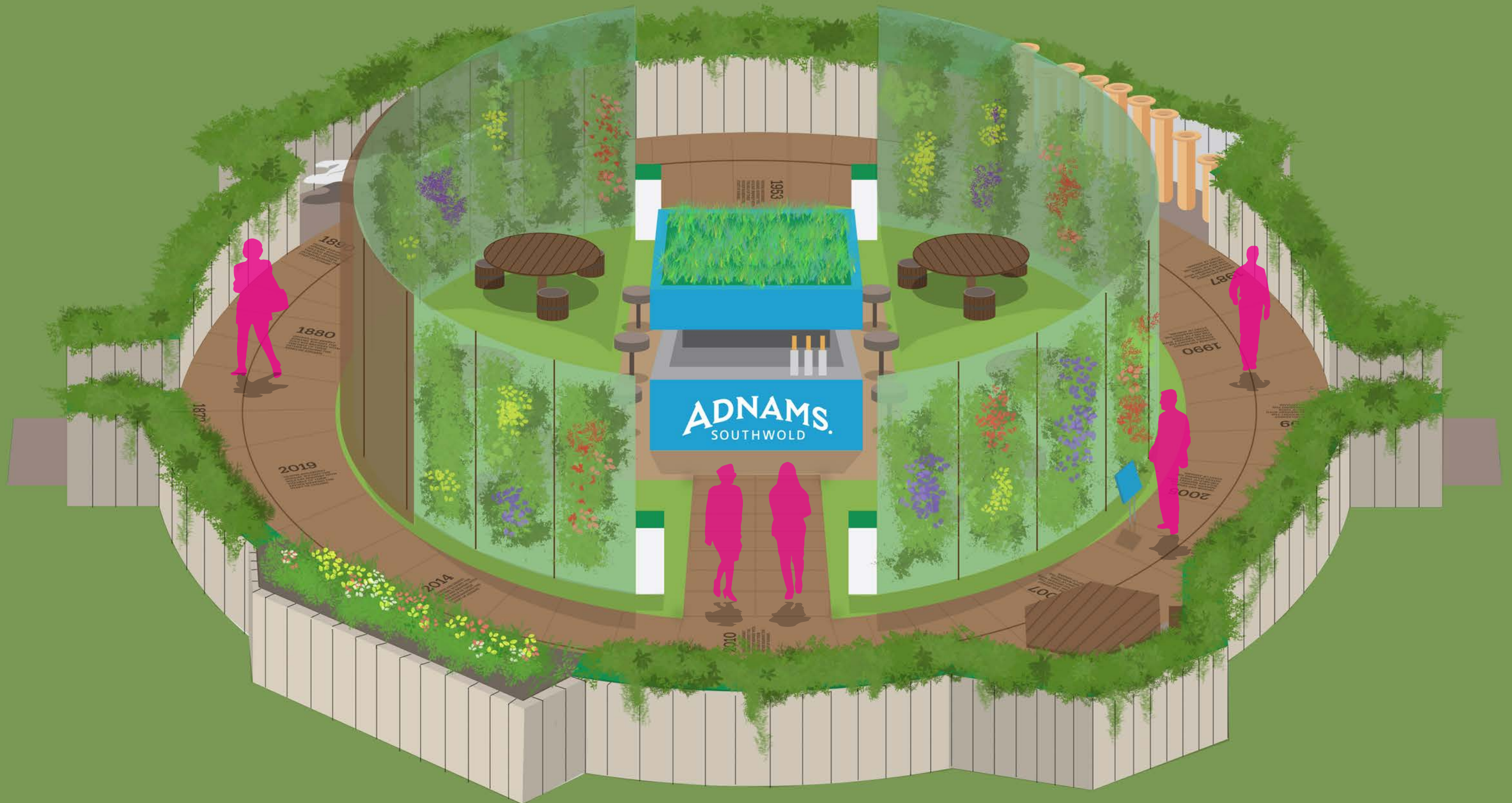

LIVE ACTIVATIONS, TO PLANT THE SEED

Before the Beer Garden begins its tour around the country, we will plant enscribed barrels and beer keg planters in busy city centers along the planned route. Each displays a message and info relating to the campaign.





LEAFLET TO INFORM

We will take advantage of Adnams existing network of partnered outlets and retailers to distribute information leaflets before the garden tour kicks off. The leaflet will give an overview of the campaign and the locations it will visit on the tour.

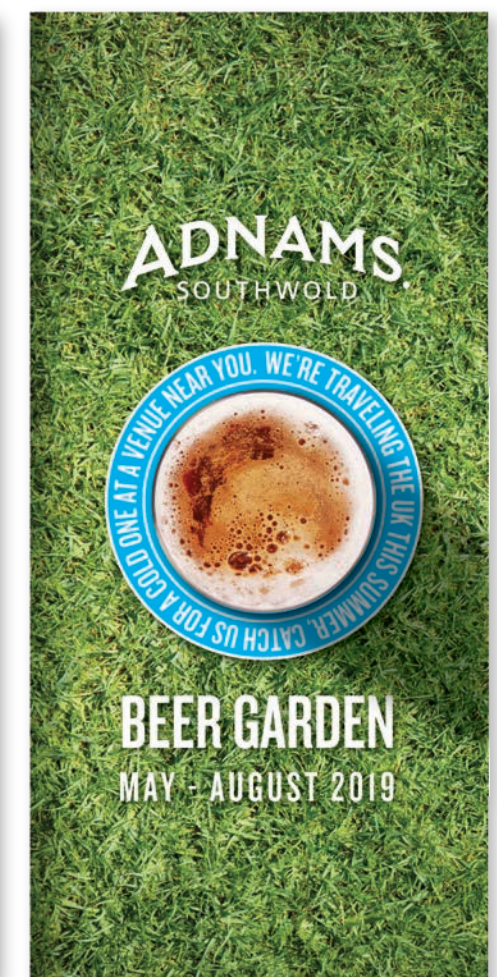

LIMITED EDITION GLASS
AND LOCATION BEER MATS

The Adnams beer garden will feature its own unique grassy beer mats, specific to each location, and distributed to pubs in each area before the garden arrives. on the tour.

The beer garden will also feature a limited edition Wild Hops bottle design and a pint glass available to purchase.



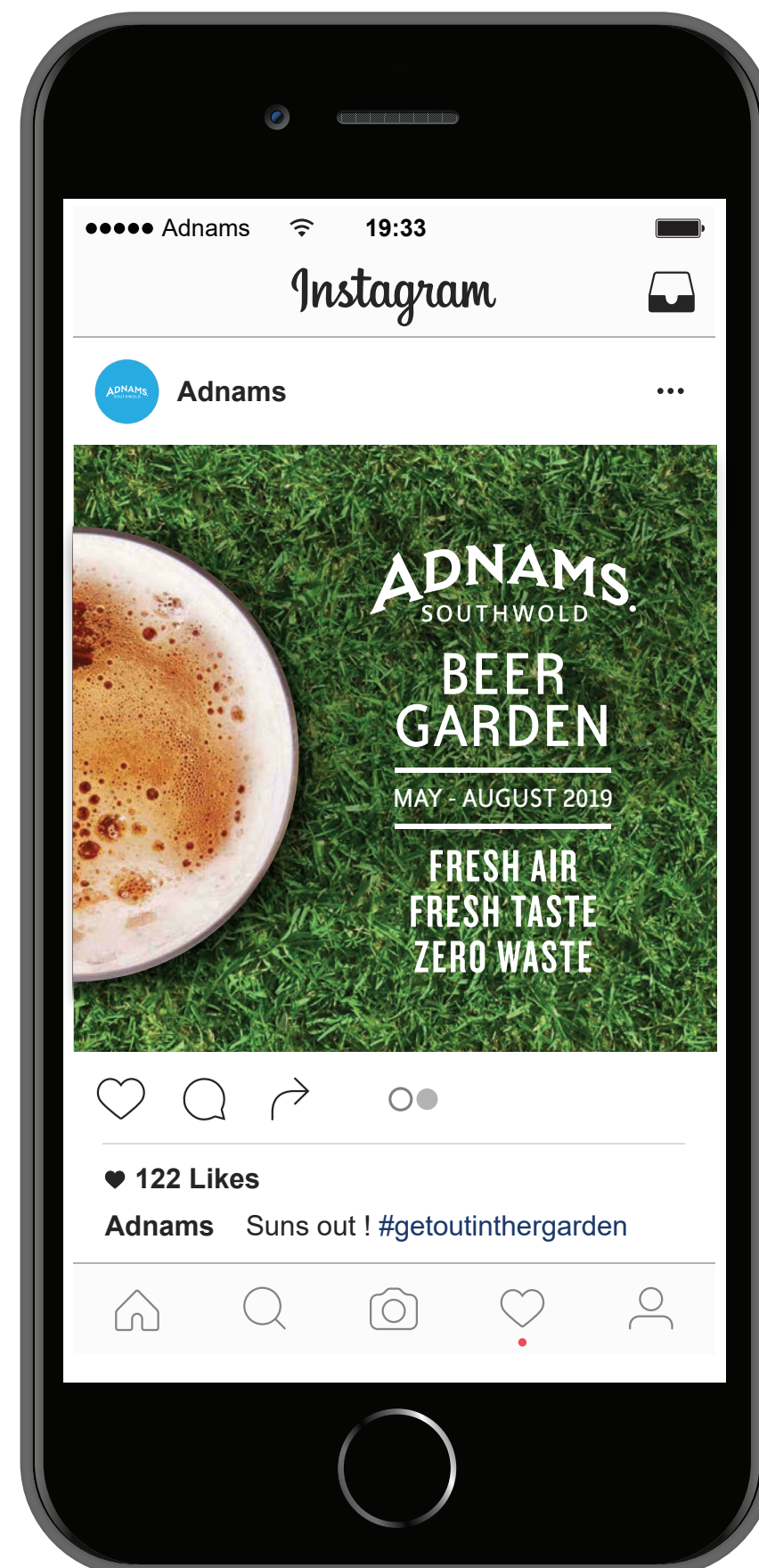
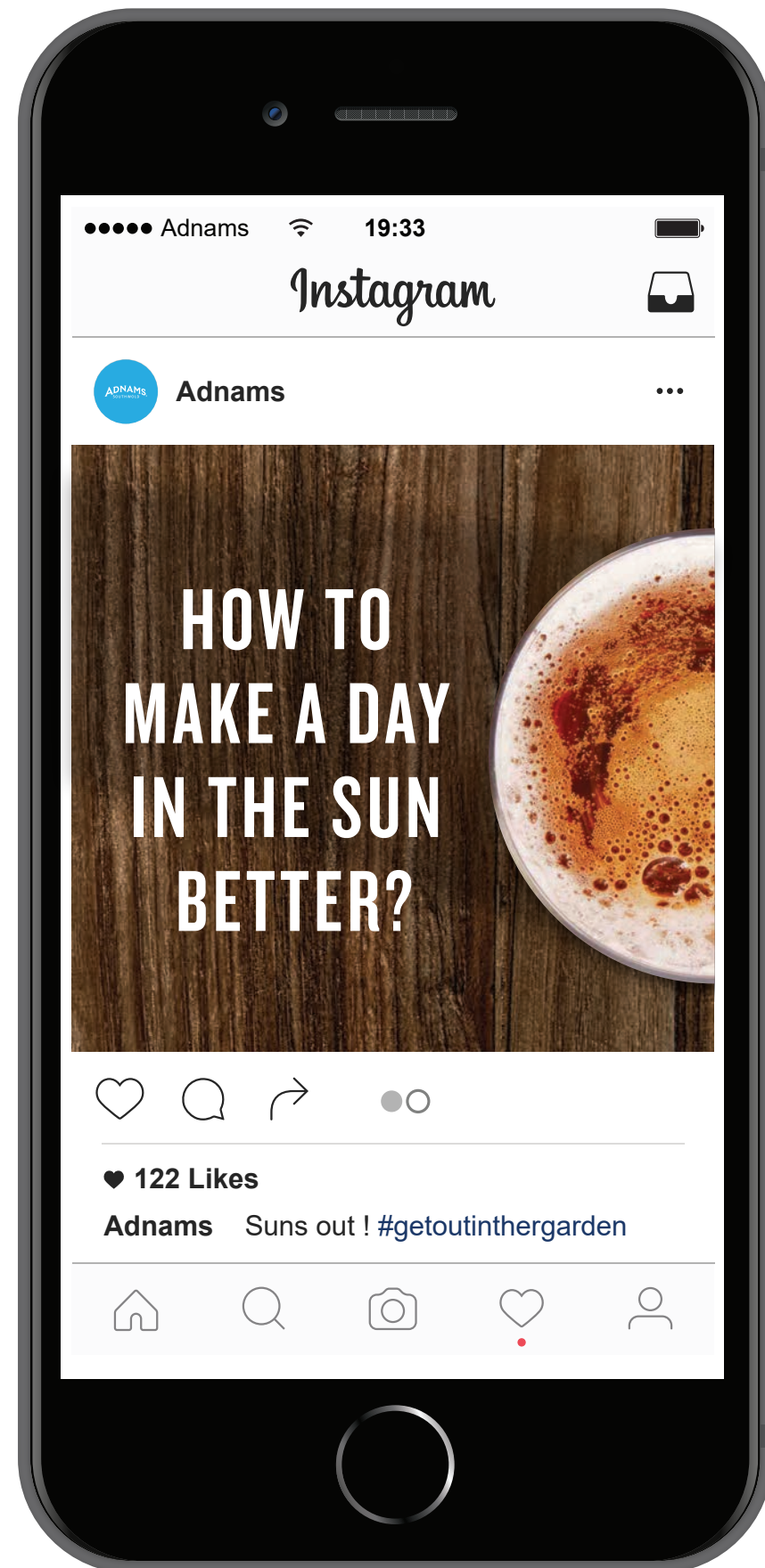

ONLINE - INSTAGRAM

Taking advantage of Adnams existing instagram account, the campaign will share a series of playful slideshow posts to coax people out of their locals and into the Adnams beer garden. The tours progress will also be posted to keep everyone informed.

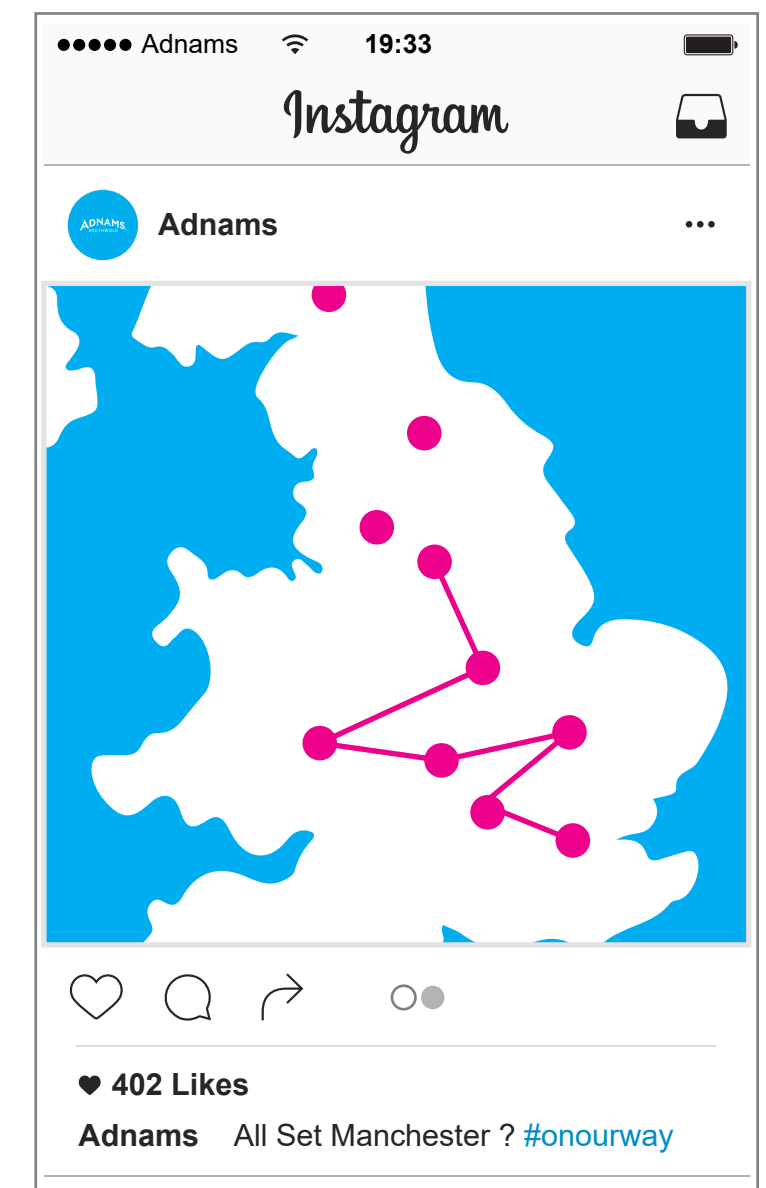

PENGUIN BOOKS NORWEGIEN WOOD

GR3333 COMPETITION BRIEF



The Brief

Haruki Murakami's books and stories have been best-sellers in Japan as well as internationally. His writing is vivid, dazzling, experimental and imaginative and your cover design should reflect this.

The story is well known both in celluloid and print so it is essential to come at it from a fresh angle. It should appeal to a contemporary, enquiring and literary readership.

The aim is to design a new cover for a new generation of readers, avoiding the obvious clichés. Originality is key.



'Evocative, entertaining, sexy and funny; but then Murakami is one of the best writers around' • **Time Out**

'Such is the exquisite, gossamer construction of Murakami's writing that everything he chooses to describe trembles with symbolic possibility' • **Guardian**

'A heart-stoppingly moving story... Murakami is, without a doubt, one of the world's finest novelists' • **Herald**

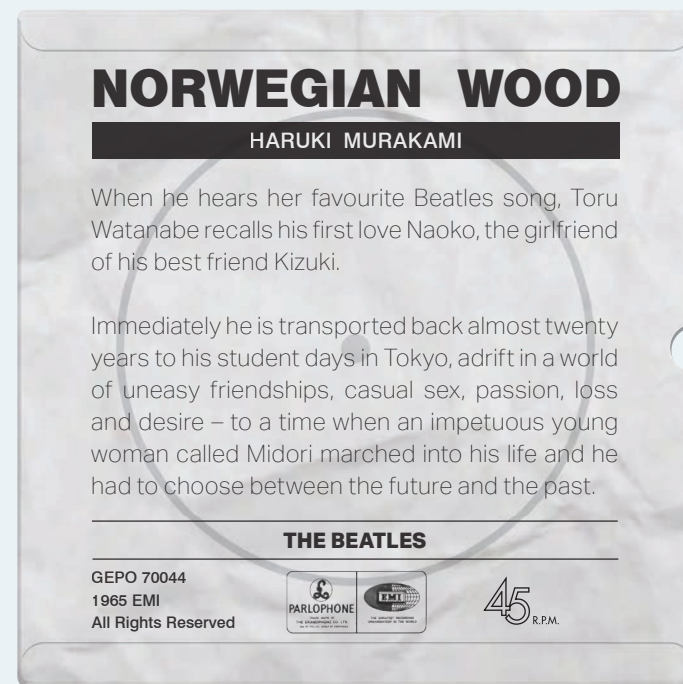

'This book is undeniably hip, full of student uprisings, free love, booze and 1960s' pop, it's also genuinely emotionally engaging, and describes the highs of adolescence as well as the lows' • **Independent On Sunday**

VINTAGE FICTION ISBN 978-0-09949-048-7 9 0000
Penguin Random House penguin.co.uk/vintage 9 780099 490487
FSC



Norwegian Wood

After reading the book I picked up on music being a key element with in the books events.

Since a song is what triggers vivid memories within the protagonist, I used a vinyl record to portray a feminine eye of the books main love interest. This particular character is deeply flawed and emotionally damaged, which I've simply visualized as scratches and chips in the record.

The spine has been styled to look like a stack of record sleeves, and features and selection of songs that play during key scenes.

The finished cover will feature a spot varnish on the record section, to replicate the glossy finish found on most vinyl records.





THE NOSTROMO LOG 40 YEARS OF ALIEN

GR3992 HONOURS PROJECT

The Brief:

To celebrate the 40th anniversary of the iconic Alien movie, this project aims to create a physical ships log book for the final voyage of the ill fated Nostromo. The book will fit with the films lo-fi aesthetic, and details the events of the film from the crews perspective.

Included with the main log-book will be a smaller pull out booklet, which tells the real world story of how the Nostromo came to be, and what its real fate was.





The Nostromo Log Book

For this project I created a log book box set, that features a host of pull-out elements that add a visual hook for key log entries.

To contain everything I also designed and created a box, that visually fits within the lo-fi futuristic aesthetic of the film. The box takes visual cues from the interior of the Nostromo, making it instantly recognizable to fans of the films while not giving away too much about what it contains.

To exaggerate this further I created a new semiotic icon that fits with existing icons, which hints that the box holds a record of some kind.



The floppy disk icon (as used as a prob in the 1986 sequel, which contains a crew members debriefing) to hint at the boxes contents.

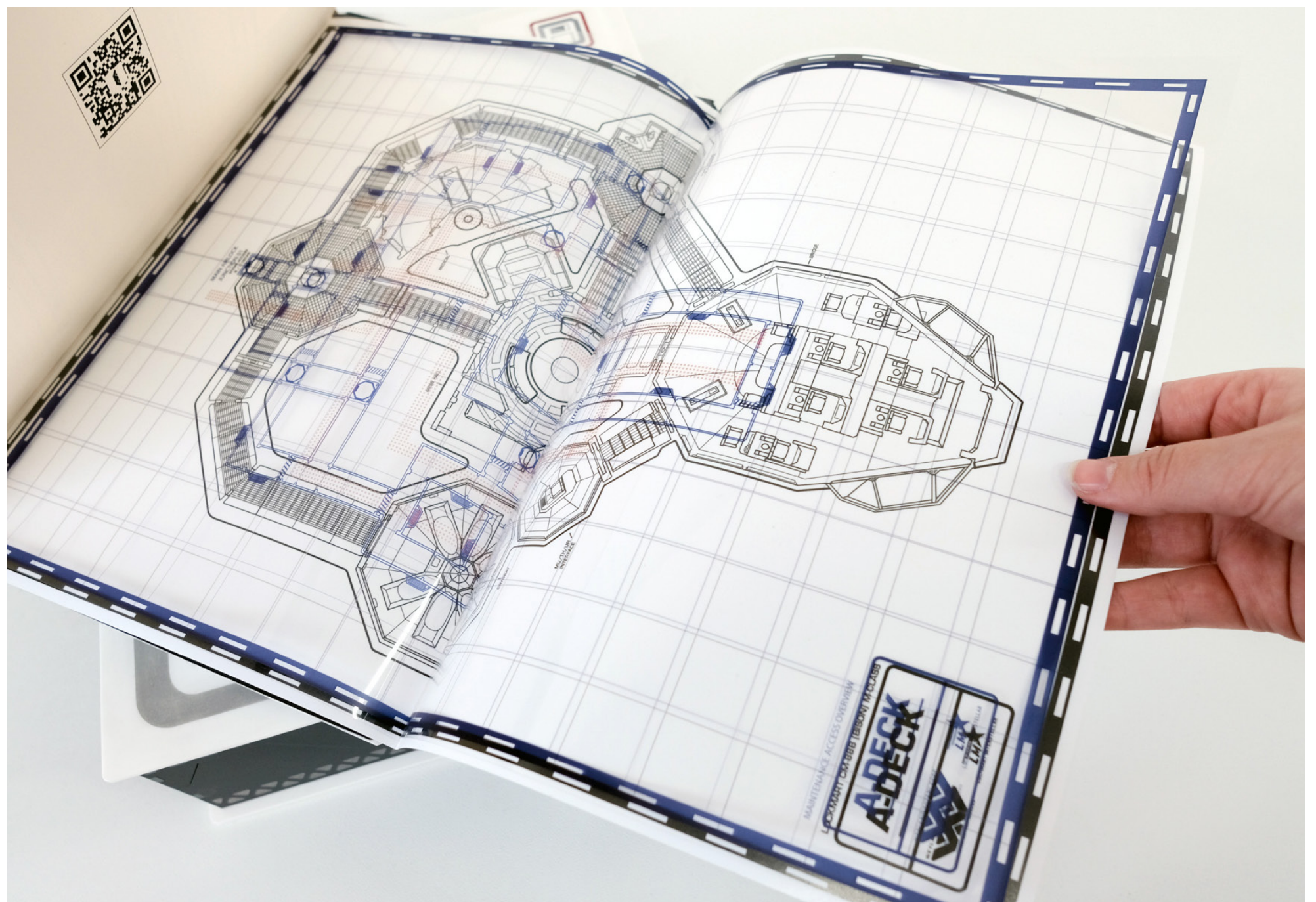
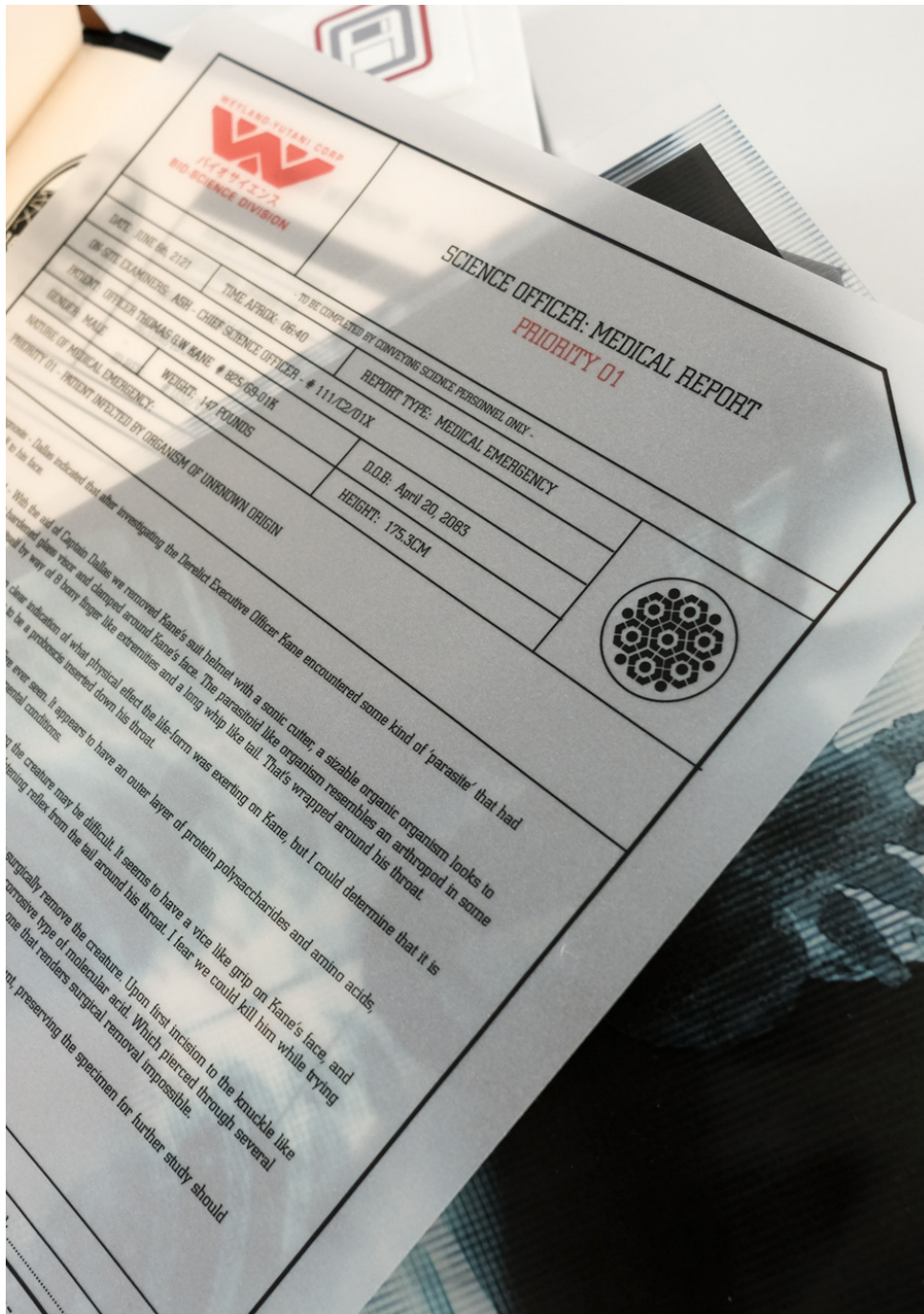

A selection of pull-out elements.

The logbook features a host of additional material to help tell the crews story. From deck plans, medical reports to oily hand drawn flame-thrower sketches.

The box also features an engraved / etched ship registration plate on the underside of the lid. The specs shown are in-canon and a result of research into the extended Alien universe.

Each log entry is also accompanied by a binary entry from the Mu/th/ur computer. These (is translated to text) detail the computers secret agenda throughout the film.

I.C.C emblem stamp

This organization is referenced several times in the film but nothing relating to it is ever shown on screen, so a more in-universe emblem was be needed for the log book.

I created a new logo in keeping with the films look, the number of stars relates to the number of colony planets the USA now has (source: Colonial Marines tech manual - 1995)



Solomons Drydock Stamp

In the original script (and later in a transcript from the in-canon Alien: Isolation videogame) the port that the Nostromo sets off from, and is due to return to, is based in The Solomon Islands.

Again this is not shown visually. So I visualized an emblem for the Solomons space-dock, using the national flag, together with warning stripes from heavy industry and the WY Company logo.

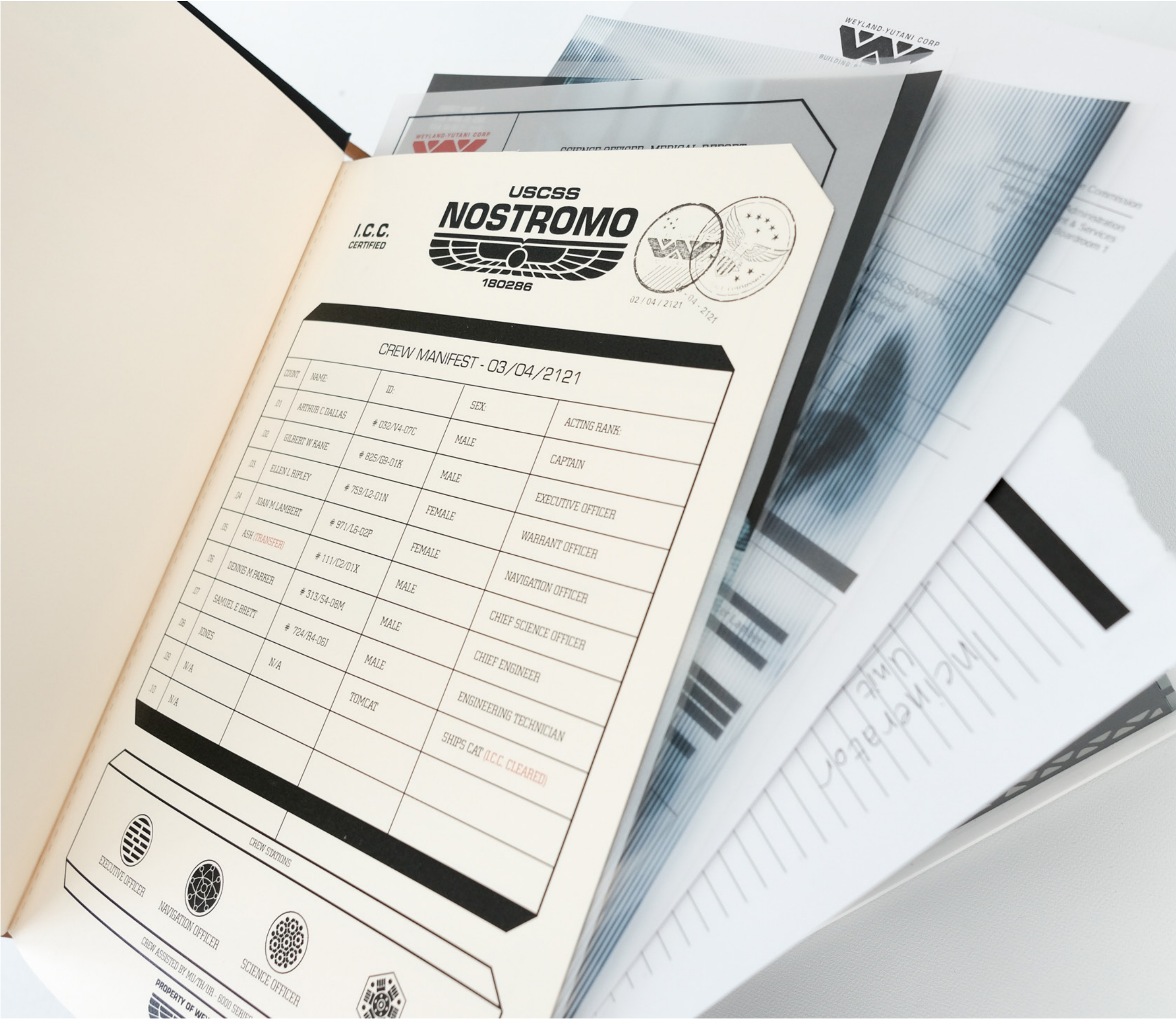



Kane's UK Arm Patch

I recreated the UK triangle patch (worn by crew member Kane) digitally, so I could have it embroidered as a physical patch to include in the log relating to his untimely fate.

The same process was done with the Nostrono crew patch, as worn by all the crew.



Embroidered Patches (Top - Nostromo crew badge / Bottom - Kane's UK-7 badge)



Both vectored and machine stitched as extra clip-in elements for the Log-Book.

JOB REF: C.N8V - WY662-2		CLIENT: TYRELL MINING DEV
USCSS REG: 180286-09		
NAME: - ACTING RANK: - ID REG:		

DATE	
ENTRY	<p>Log entry format, which emulates a naval log book. Each entry will be accompanied with a crew rank icon and binary back-up log from the mu/th/ur computer.</p>
STATUS	

MU/TH/UR - BACKUP LOG	
01110100 01100001 01101011 01100101 00100000 01101111 01100110 01100110 00100000 01110011 01110101 01100011 01100011 01100101 01110011 01110011 01100110 01110101 01101100 00101110 00100000 01100001 01110111 01100001 01101001 01110100 01101001 01101110 01100111 00100000 01110011 01100011 01101001 01100101 01101110 01100011 01100101 00100000 01100001 01110011 01110011 01100101 01110100 00100000 01110010 01100101 01110000 01101111 01110010 01110100 00101110	
SERIES 6000	

L.C.C. CERTIFIED LOG BOOK - REG: 2101

PROPERTY OF WEYLAND YUTANI



Each log entry is partnered with a unique Weyland Yutani branded QR code, which will take you directly to a video of the scene linked to that particular log entry.

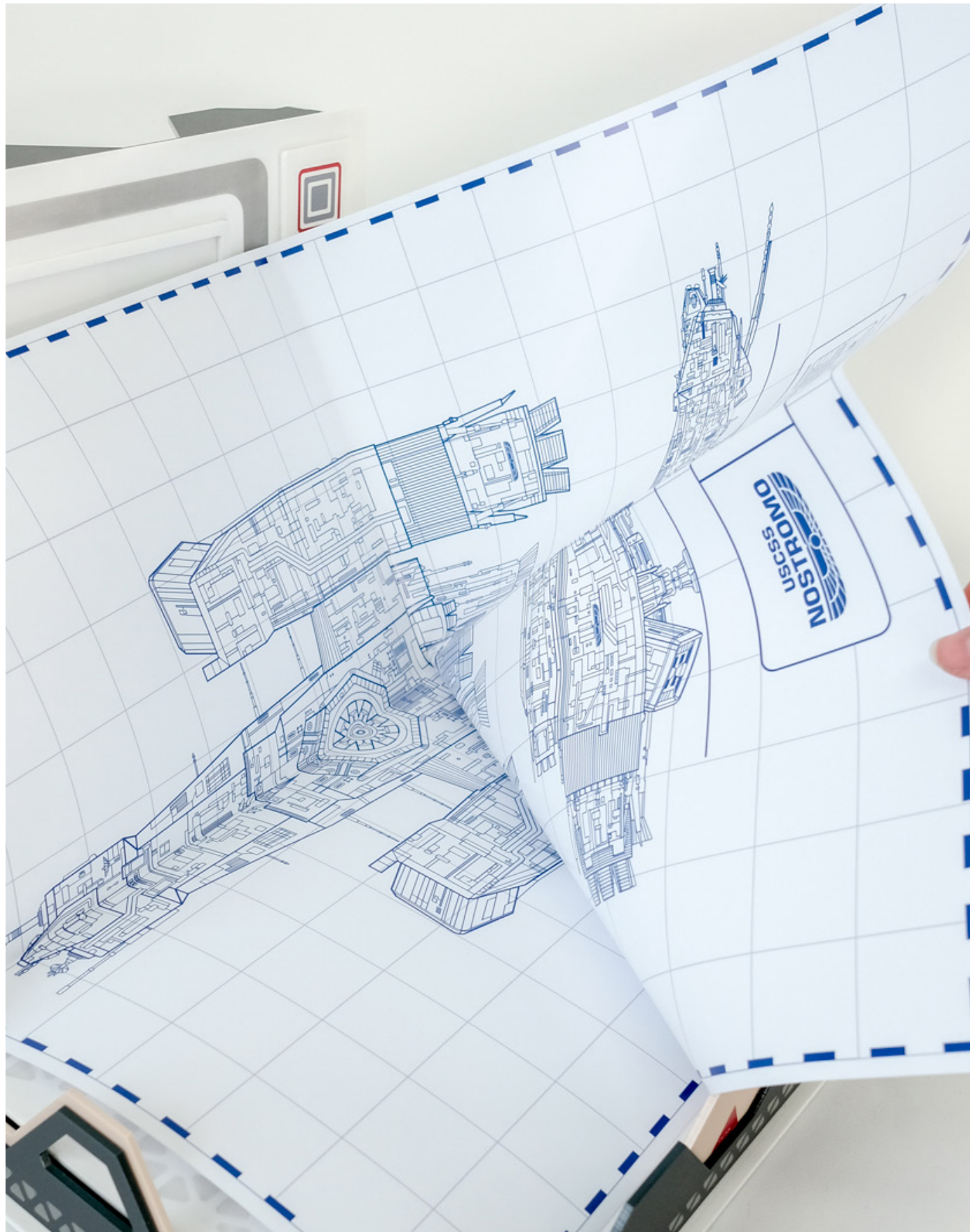

Nostromo ship schematic

I envisioned that if this box existed on a real ship it would include a schematic of the ship itself. So using film stills and fan artwork as a reference, I created a vector of the ships structure and printed it in large format to be folded into the box.

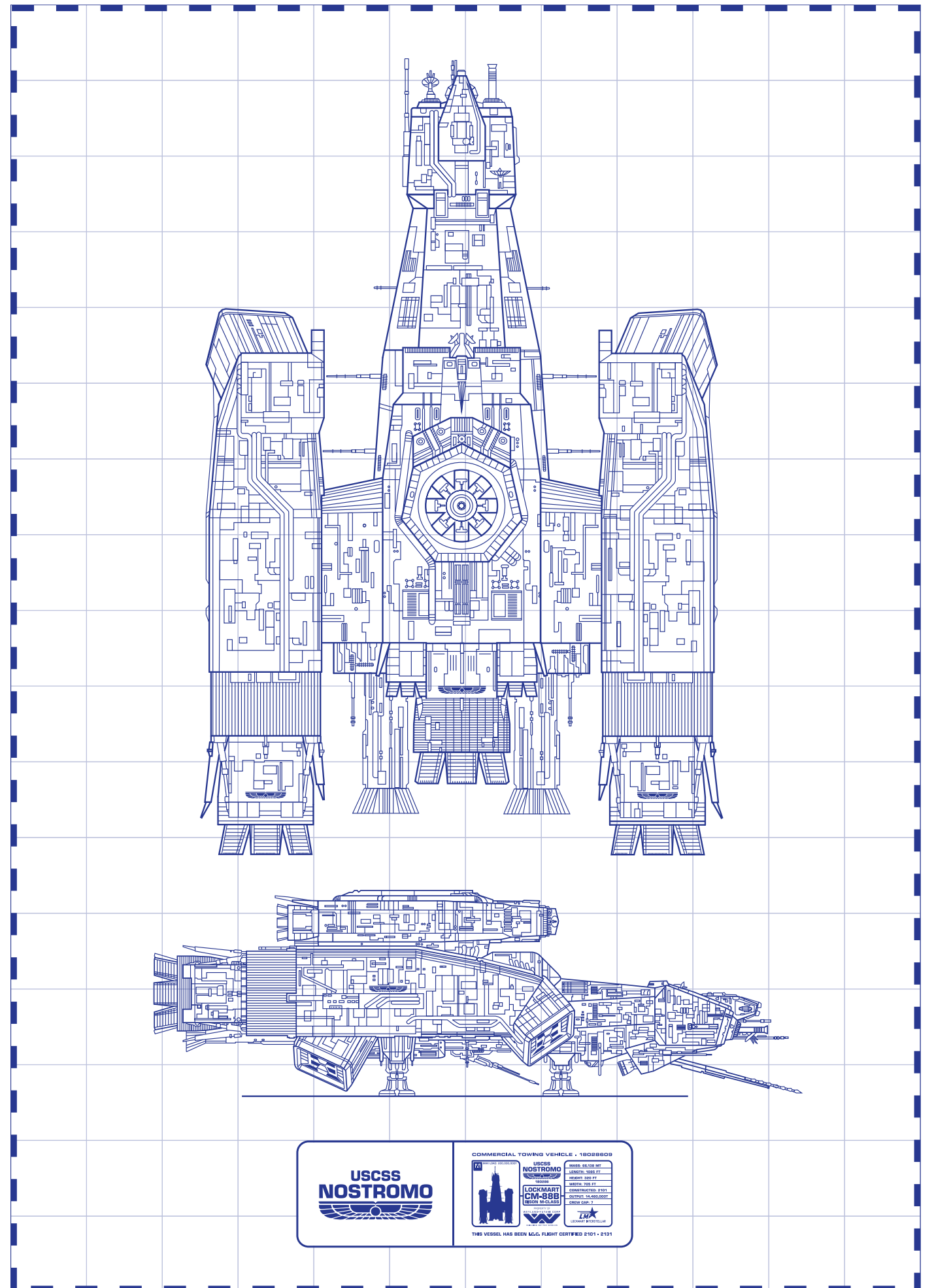

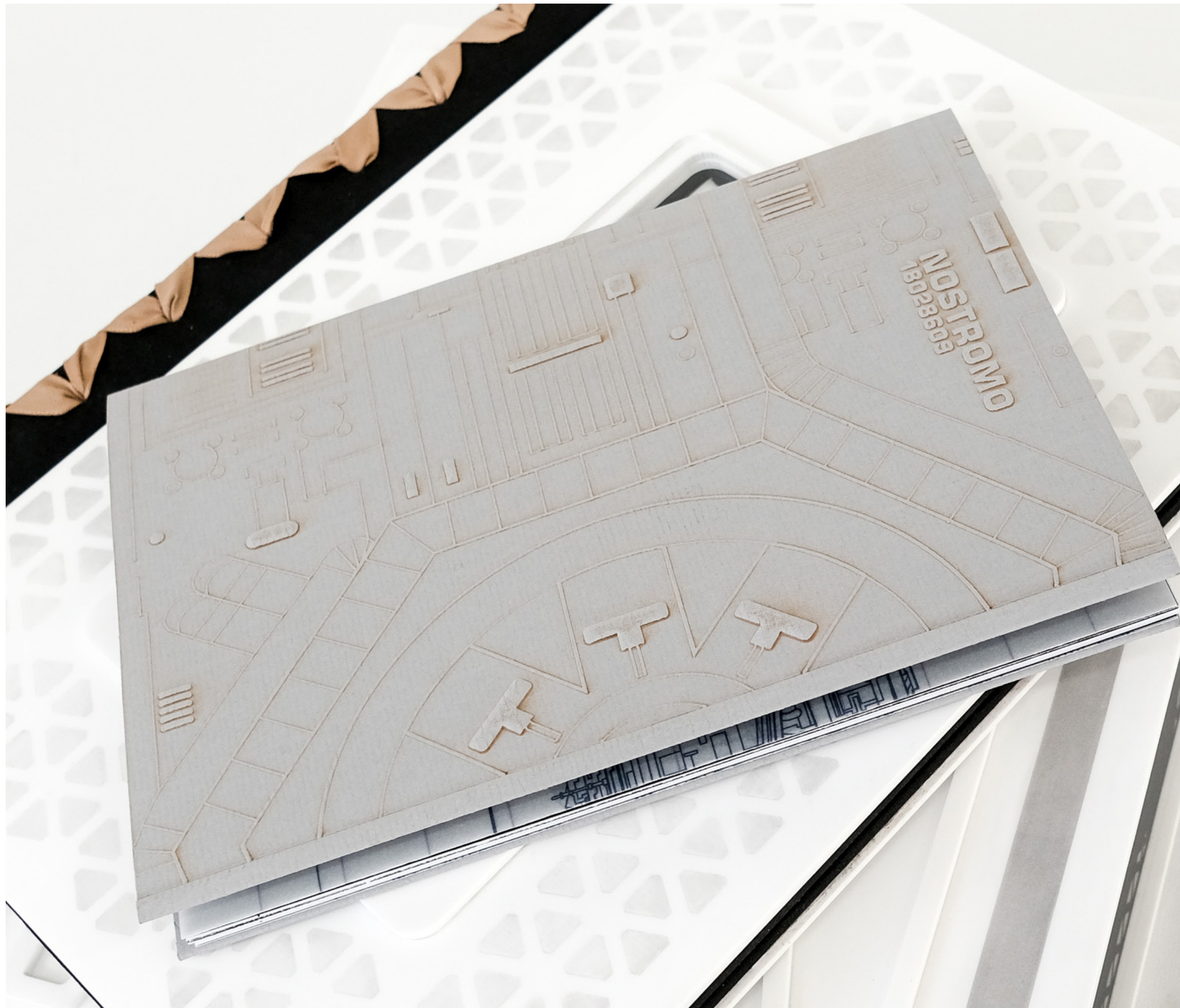

Companion Booklet

In addition to the main (in-universe) log-book I also created a smaller supplementary booklet, which details the incredible work that went into designing and building the Nostromo from the film. The book features gate folded pages which contain a wealth of images of the of Nostromo sets.

The booklet also features a unique hand embossed wraparound cover, which emulates the aged hull of the Nostromo itself.

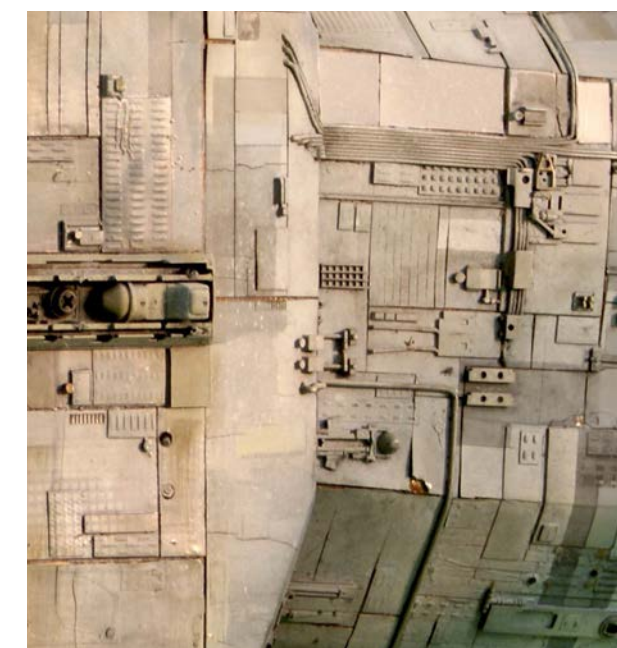

An example of the Nostromo model's hull paneling, as seen on screen in the film.



